

# Installation Instructions for Bravat Oil Rubbed Bronze Automatic Sensor Faucets



Prior to Installation:

Make sure you have all necessary parts by checking the diagram and parts list. If any part is missing or damaged, please contact Juno showers Customer Service at 800-297-0232 for a replacement.

•Turn off the hot and cold water supply at the angle stops and turn on the old faucet to release any built up pressure. Remove existing faucet. Clean sink or countertop to remove any debris, plumber's putty, or silicone • Place bucket under angle stops. Turn on angle stops to flush any debris prior to installing new plumbing. Shut off angle stops

•Pre-drilled hole size requirement: 1 3/8" (min)

•Max countertop thickness: 1 3/8"

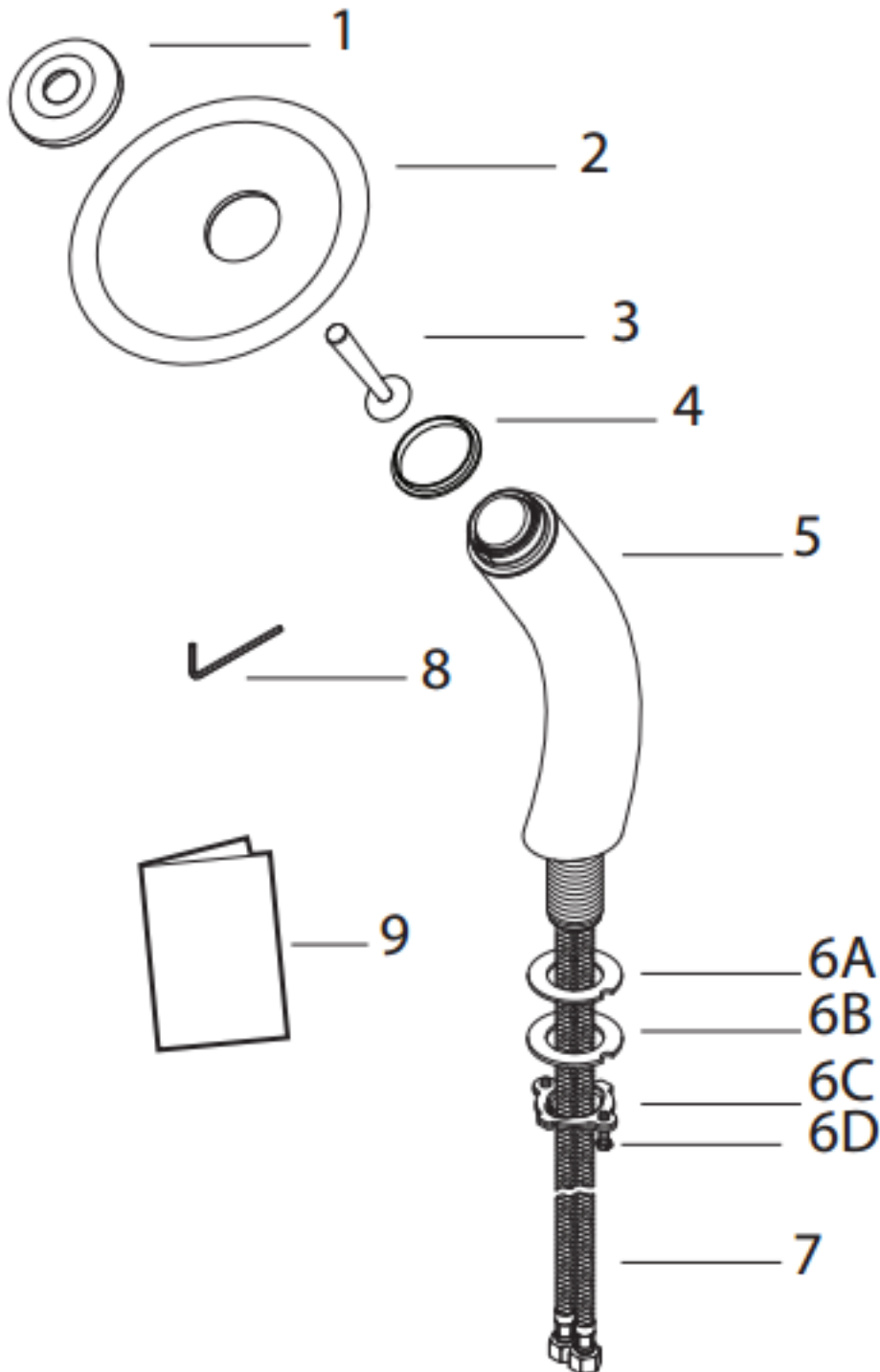

## Diagram and Parts List

1. Decorative Ring
2. Glass Disc
3. Lever
4. Seal for Glass Disc
5. Faucet Body
6. Mounting Hardware
  - (A) Rubber Washer
  - (B) Metal Washer
  - (C) Mounting Nut
  - (D) Mounting Screws
7. Hot & Cold Waterlines (2)
8. Hex Wrench
9. Manual

## Tools you will need:



Adjustable Wrench

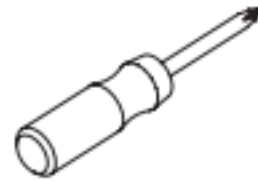

Phillips Screwdriver



Pipe Tape

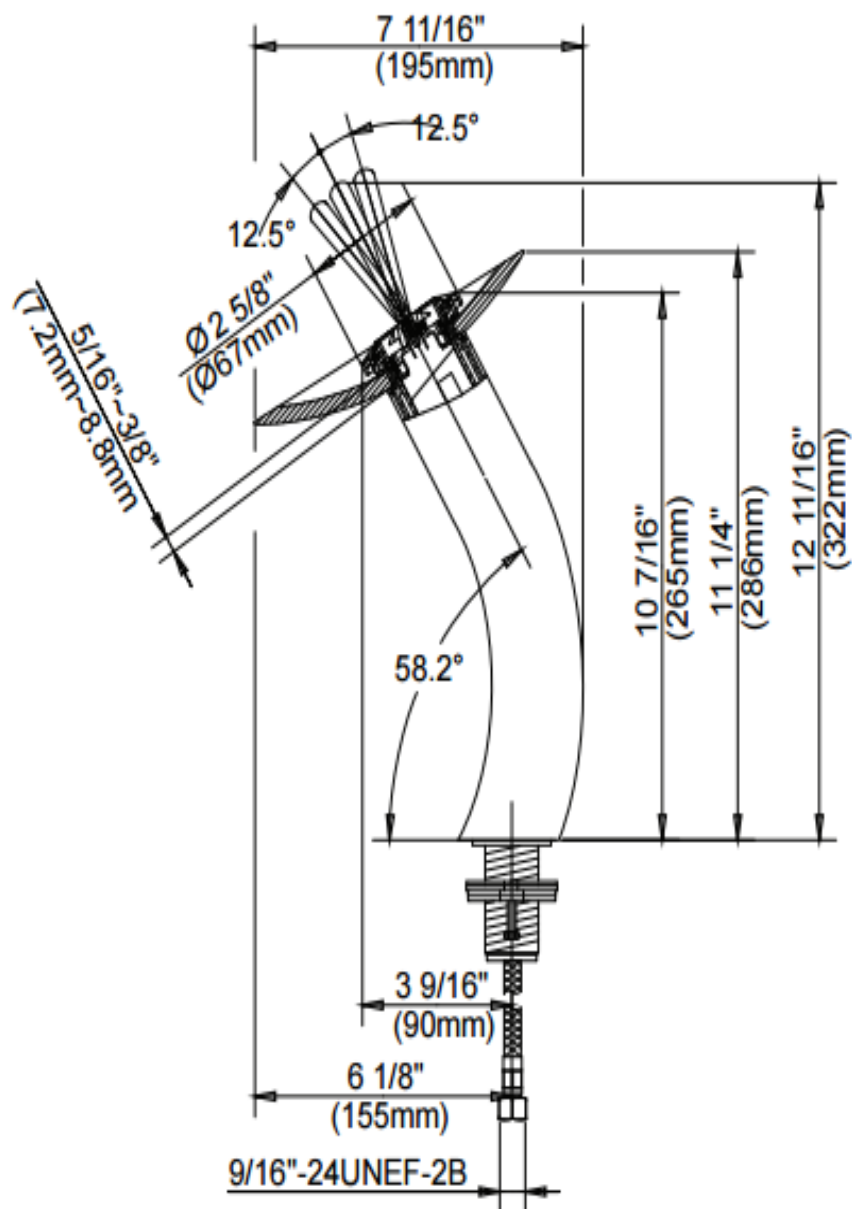
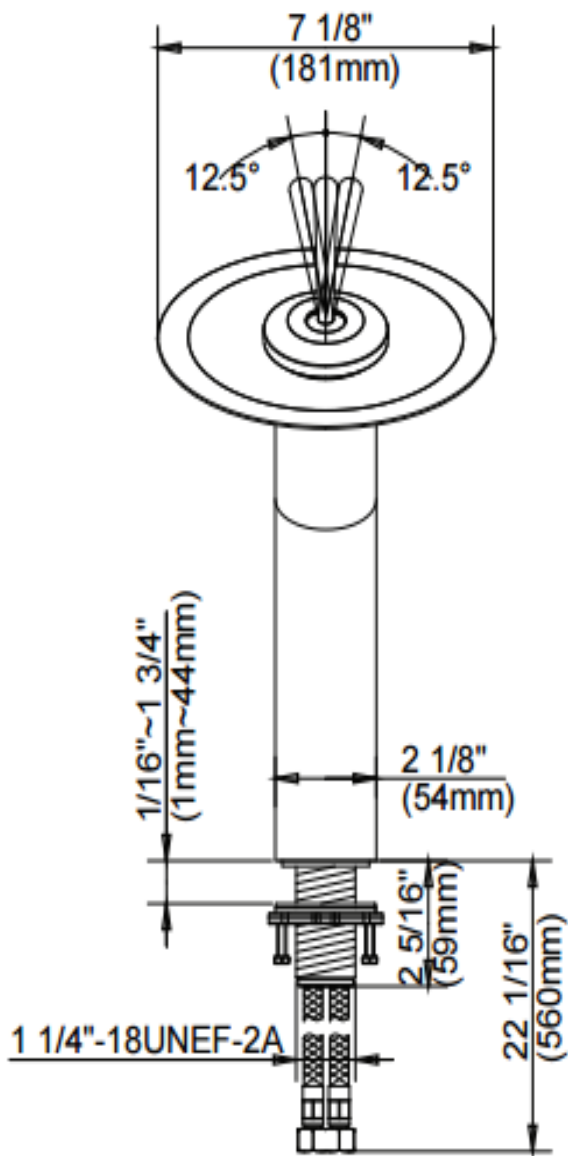

## Step 1: Remove Mounting Hardware

---

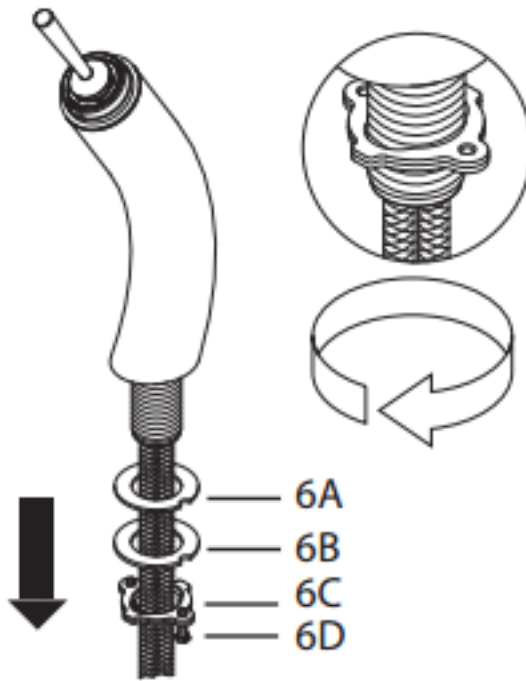

Remove mounting hardware (6A, B, C, & D) from the mounting pipe

## Step 2: Remove Decorative Ring

---

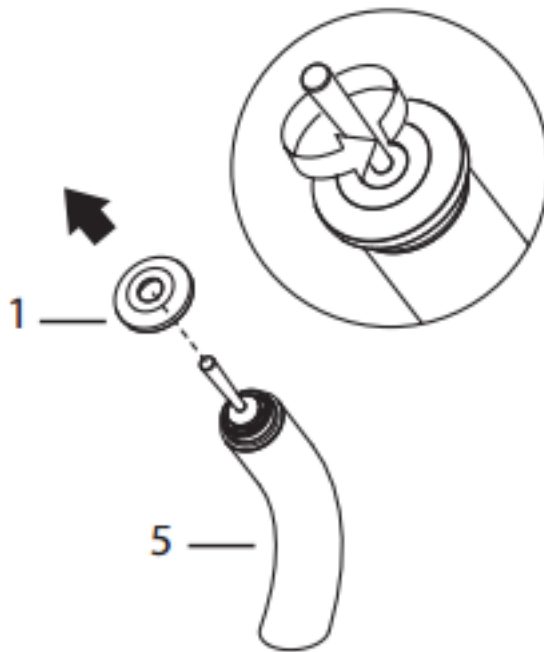

Remove decorative ring (1) from faucet body (5)

### Step 3: Install Glass Disc

---

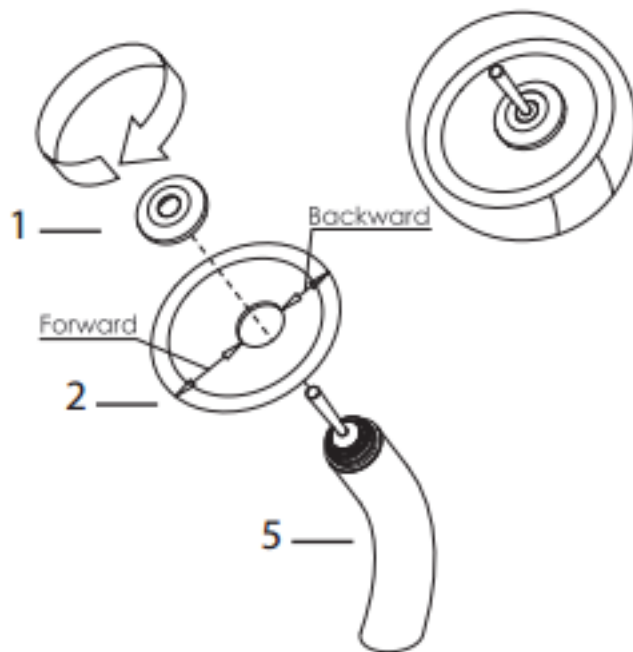

Install glass disc (2) on faucet body (5). Secure it using decorative ring (1)

**NOTE:** Hand-tighten only (decorative ring)

### Step 4: Install Faucet

---

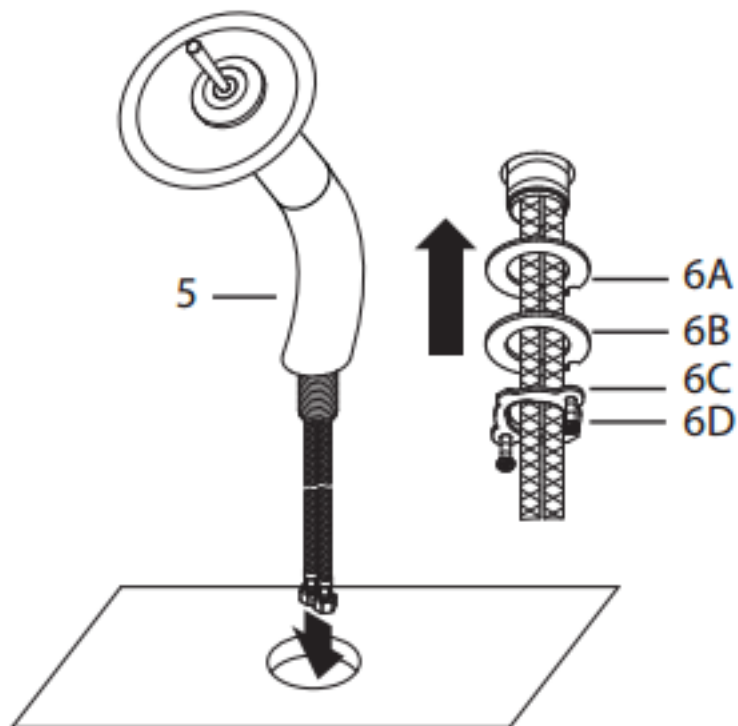

Insert faucet body (1) into the hole on the countertop. Attach rubber washer (6A), metal washer (6B), mounting nut (6C), and mounting screws (6D) from underneath the sink

## Step 5: Secure Mounting Hardware

---

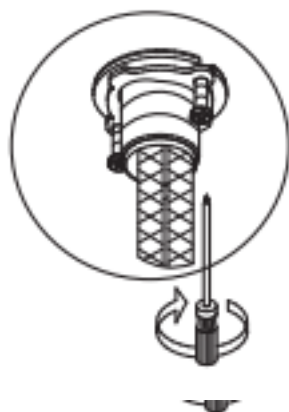
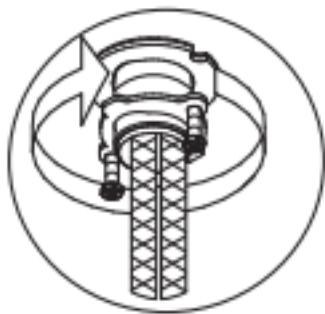

Adjust direction of faucet body (5). Tighten mounting nut (6C) until snug. Tighten mounting screws (6D) to nut with a Phillips head screwdriver until snug

## Step 6: Connect Waterlines to Main Valve

---

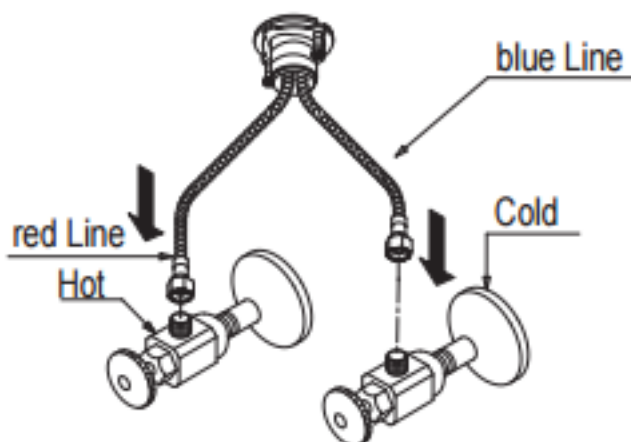

Connect hot and cold waterlines (7) to the angle stops. Tighten with a wrench until snug. Turn on hot and cold angle stops and check for leaks

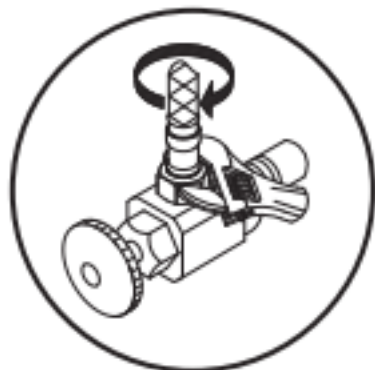

**NOTE:** Make sure O-rings are installed on both ends of the hot & cold waterlines

## Step 7: Flush Faucet

---

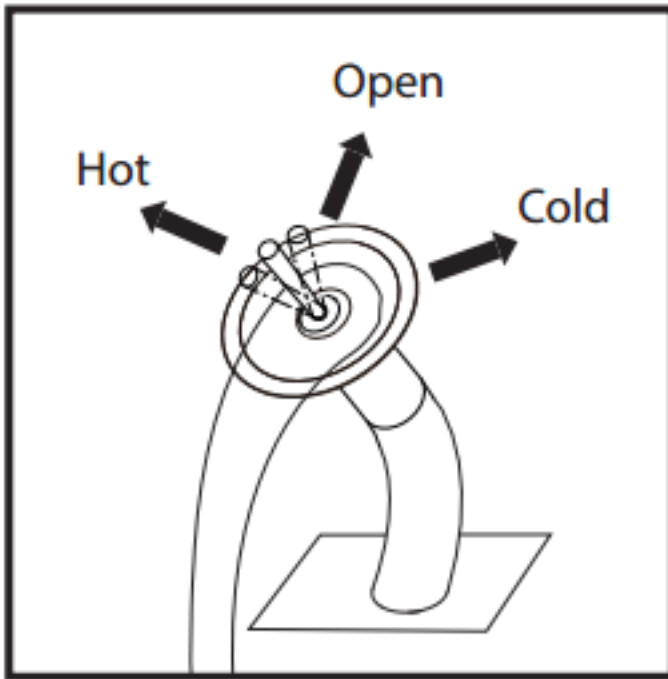

Turn water on for a minute to ensure proper water flow

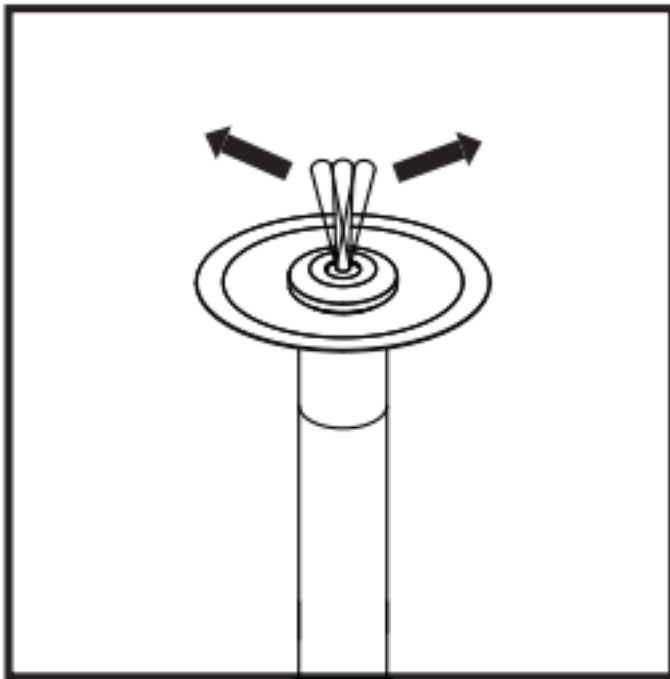



## Replacement Parts

1. (A) Decorative Ring  
(B) O-ring
2. Glass Disc
3. Lever
4. Seal for Glass Disc
5. Locking Nut
6. Cartridge
7. Flow Restrictor
8. Hot & Cold Waterlines
9. Mounting Hardware  
(A) Rubber Washer  
(B) Metal Washer  
(C) Mounting Nut  
(D) Mounting Screws
10. Hex Wrench

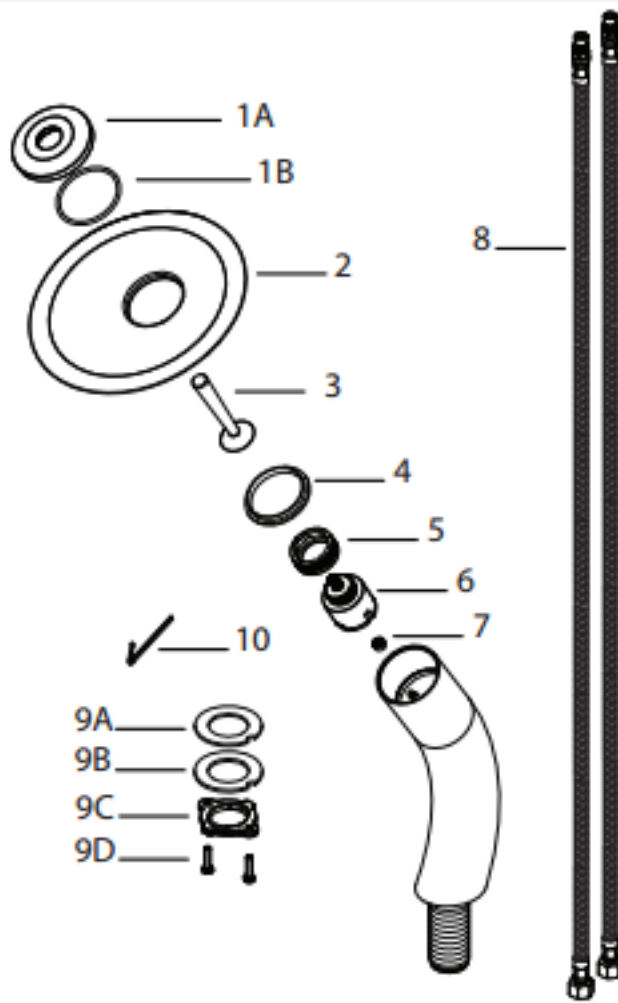

## Trouble - Shooting

If you have followed the instructions carefully and your faucet still does not work properly, take the following corrective steps:

PROBLEM	CAUSE	ACTION
Leakage under the handle	Locking nut has come loose	Unscrew the decorative ring (by hand) and remove the glass disc. Loosen set screw with a hex wrench located underneath lever and remove lever. Tighten locking nut with a reversible wrench
Water will not shut off completely	Cartridge may be defective	Unscrew decorative ring (by hand) and remove glass disc. Loosen set screw with a hex wrench located underneath lever and remove lever. Unscrew locking nut with a reversible wrench. Remove ceramic disc cartridge. Check for cracks
Drain is leaking	Washers may be compromised or installed incorrectly	Check washers to make sure they are installed correctly and not cracked

This general Diagram and installation are not intended for any specific model, but is presented as a general guideline for installations!.